

RIMAC 4th Floor Conference Room configurations

Максимуми гооми оссирансу: 54
808 SQ.FT.

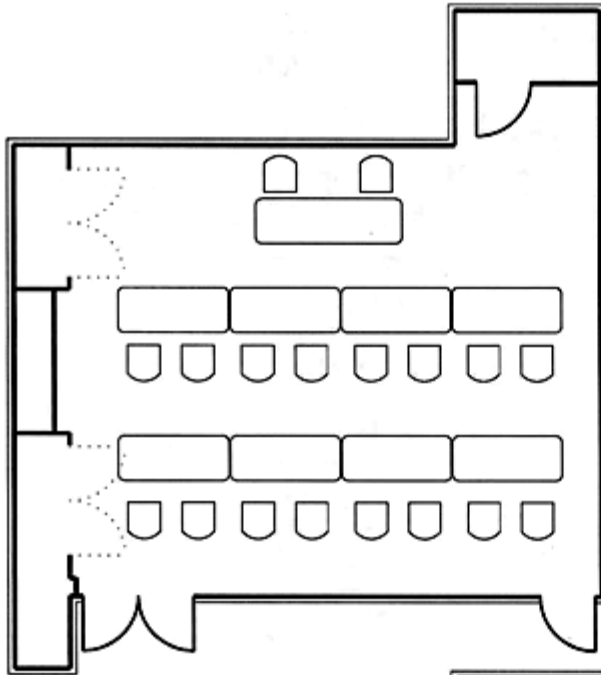

Classroom Set-up

- 8-6' tables in 2 rows
- 2 chairs at each table
- 8' head table with up to 4 chairs
- White board available
- Podium with mic available

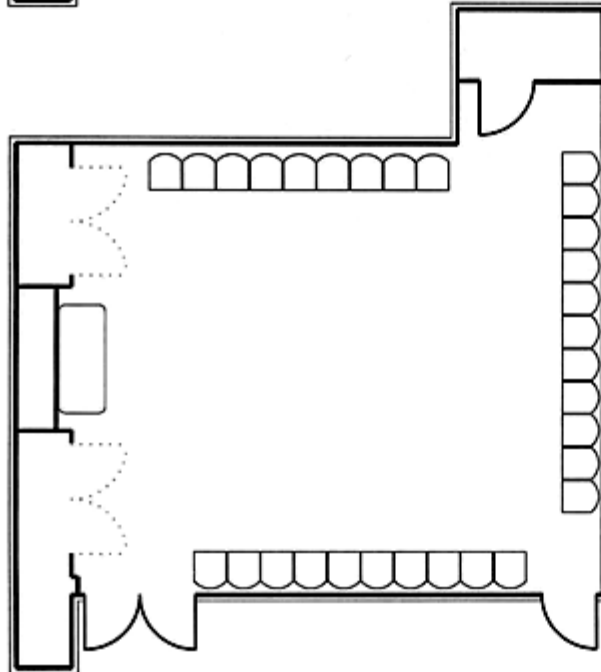

Reception Set-up

- 1 to 4-6' tables
- 30 chairs around room perimeter

